



# NetCon-SXL-USB



## USB-Device-Server for the integration of USB-HID devices into a network

**Without the system driver** you can now integrate USB input devices such as a keyboard, barcode scanner, RFID reader, Smart Card Reader, SignPads, PinPads etc. into a network. The only requirement is that your USB terminal is a HID device (USB class 03). All input data such as keystrokes, barcode scans, RFID data etc. can be directly requested or sent as ASCII data via TCP/IP. In addition, the data connection can be secured against unauthorised access by third parties with integrated SSL/TLS data encryption. Furthermore, the individually adaptable Web interface allows you to integrate your personal website. Printers (USB class 07) can also be connected without system drivers and consequently be used in the network.

Connection options:

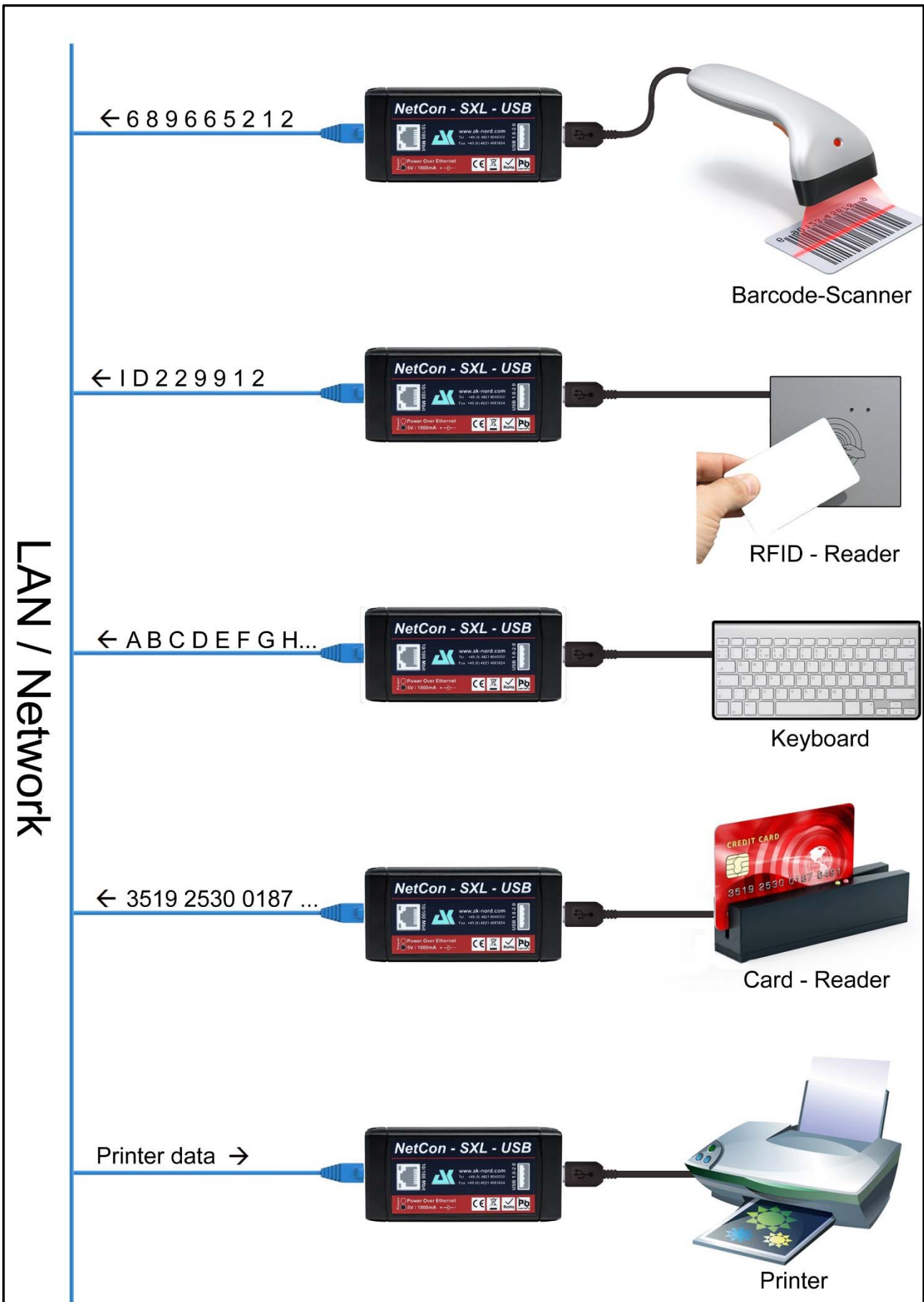

## Technical data

- **Dimensions:**  
40 x 21 x 82 mm (WxHxL)
- **Housing:**  
Impact-proof plastic
- **Weight:**  
37 grams
- **Temperature range:**  
-40°C ..+ 70°C
- **Standards:**  
CE / WEEE / RoHS-II  
EN 55022 Class B  
EN 55024 Class A
- **Power supply:**  
-Switched power supply 5Volt, 2A  
-PowerOverEthernet IEEE802.3af
- **Power consumption:**  
5 Volts / ca. 200 mA
- **Connectors:**  
1 x Ethernet RJ45  
1 x USB-A Jack
- **Ethernet (M-DIX)**  
10 Half Duplex  
10 Full Duplex  
100 Half Duplex  
100 Full Duplex  
AutoSensing
- **USB 1.0, 1.1, 2.0**  
Host Mode  
- Class 03 HID  
- Class 07 Printer  
- Class 09 Hub

## Supported protocols IP-Dual-Stack

- IPv4
- TCP
- UDP
- FTP
- FTPS
- TFTP
- ICMP
- ARP
- SNMP
- LPR
- DHCP
- BOOTP
- DNS
- TELNET
- HTML
- HTTP
- HTTPS
- DYNDNS
- SMTP
- POP3
- SYSLOG
- AK-M2M
- IPv6
- NDP
- ICMPv6
- DHCPv6
- TCPv6
- UDPv6
- Netbios-NS
- LLMNR
- ZeroConfig  
-APIPA  
-AutoIP
- IP-Multicast
- IEEE802.1x
- SSL 3.0
- TLS 1.0
- TLS1.1
- TLS1.2

## Management

1. Telnet
2. Browser

## Views



Front with power supply connector



Front with PowerOverEthernet



Rear side with USB connector

## Emulations and functions

- Connect-On-Data
- Auto-Connect
- DYNDNS-Client
- FTP-Server
- LPR-Server
- 512KB internal flashdrive
- Flash-File-System
- E-Mail – Client
- TCP/UDP -Client
- TCP/UDP –Server
- SYSLOG-Client
- AKM2M

## Order numbers

**NetCon-SXL-USB-NT**  
**NetCon-SXL-USB-POE**

with switched power supply 5Volt, 2A  
with PowerOverEthernet IEEE802.3af

## Safety

- SSLv3
- TLS1.0
- TLS1.1
- TLS1.2
- IEEE 802.1x